

Tolcyclen™

ANTIFUNGAL/NAIL RENEWAL SOLUTION



Precision brush tip

Proprietary filter & valve

1 Prior to first use

For best results and to ensure safety, read the instructions before use

Watch the how-to-apply video for more detailed instructions here:



Scan Here

2 Priming the tube

Point the tube down and gently squeeze and release until the brush tip becomes lightly wet with the solution

To avoid deflating the tube, never squeeze with the brush tip pointing up



3 Instructions

Check the brush before use. If it is not still wet from your previous use, **repeat step 2**

Twice a day on each nail, apply a thin layer:

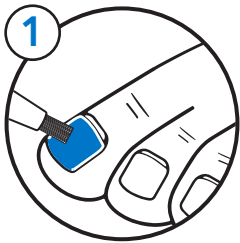

On the entire nail plate

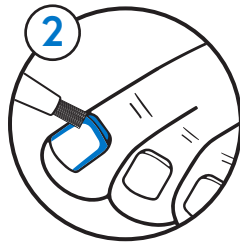

Around the edges of the nail

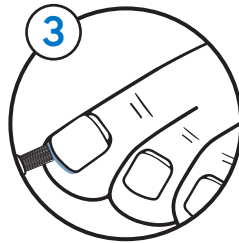

Under the tip of the nail

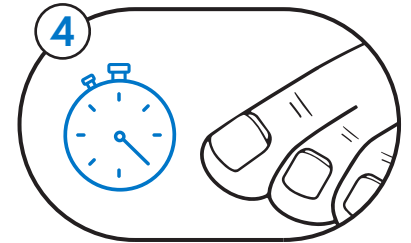

Wait until it is dry to put shoes on. If it isn't dry within 2 minutes it was likely over applied

4 For best results

- Use once in the morning and once at night, or as directed by your physician
- Do not over-apply the solution, only a thin layer is necessary
- While it is normal to contact the skin around your nail, avoid applying excess solution directly on the skin
- Be consistent with your application, results can range from visual changes within days to up to 12 months for total nail clearance

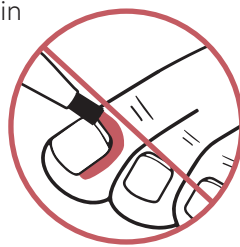

Scan for Spanish instructions

Escanea para obtener información detallada e instrucciones en español

! Additional Information

For external use only • Avoid contact with eyes • Do not use if you are allergic to any of the listed ingredients • Keep out of reach of children • Store in a cool, dry place • Securely tighten the cap after each use • Over applying the solution can cause irritation of the skin surrounding the nail in some patients • If irritation does occur, contact your physician • If pregnant or breastfeeding, consult your physician before use

? Frequently Asked Questions

Q: How is Tolcyclen different from generic Tolnaftate and other topical antifungal products?

A: Tolcyclen is the result of many years of scientific research and collaboration with leading physicians to develop the most effective antifungal drug for fungal infections of the nail bed. It is the only product to combine clinically proven nail renewal ingredients, cosmetic ingredients, and an antifungal drug in a patented low surface tension delivery vehicle designed to penetrate nails. Other antifungal and cosmetic nail products utilize thick emulsions, creams, gels, oils, and water-based delivery vehicles that limit penetration and are only intended for use on skin.

Q: How long until I see results?

A: Results vary based on the condition of your nail, how consistent you are with the application, and other factors. Some patients see visible changes within days, while others take a month or more. To cure the infection and fully renew a dystrophic nail, it may take as little as one month, or as long as one year.

TIP: To easily track progress, take a photo of your affected nails in similar lighting at regular intervals.

Q: How long will my Tolcyclen Solution tube last?

A: With proper use, your Tolcyclen tube should last more than three months when treating ten toes, twice daily. If you run out sooner, you are likely over-applying the solution on your nails.

Q: Why is Tolcyclen Solution only available through physicians?

A: Tolcyclen is most effective when used as directed by your physician for your specific condition.

Q: Can I use it over nail polish?

A: For best results, apply Tolcyclen to the bare nail plate. Nail polish can be used over Tolcyclen once it is dry, but must be removed before the next application.



The Science of Tolcyclen

Your nails are complex and difficult to treat. Rapidly improving nail appearance and effectively treating fungal infections requires:

1. Ingredients that repair visual damage
2. An antifungal drug
3. A delivery vehicle capable of moving through the nail

The Tolcyclen Difference

Tolcyclen combines Tolnaftate with the proven nail renewal ingredients, Urea, Lactic Acid, and Propylene Glycol, in a patented delivery vehicle that allows these ingredients to penetrate throughout the nail plate. How is this different from other available treatments?

Prescription topical drugs are costly, have low clinical cure rates, and do not contain nail renewal ingredients that rapidly improve appearance.

Prescription oral drugs require blood tests, monitoring of liver function, and do not contain nail renewal ingredients.

Other over-the-counter drugs utilize delivery vehicles that do not penetrate the nail and lack the ingredients required to be effective.

Patented Delivery Vehicle

Marlinz Pharma developed Tolcyclen to have ultra-low surface tension and low molecular weight, allowing the ingredients to move through the keratin matrix in your nails for optimal penetration. It also contains ingredients that break down the keratin in nails to help penetrate further and ingredients that are proven to remove fungal biofilms, which act as a barrier to typical antifungal drugs. This revolutionary approach has resulted in multiple patents for its penetration capability and the complex process required to formulate and stabilize the Tolcyclen Solution.

Interactions Between Nails and Topical Drugs

The interaction between nails and topical treatments is surprisingly complex. There are polar molecules that are attracted to water (hydrophilic) and non-polar molecules that are repelled by water (hydrophobic). The nail plate consists of a keratin matrix with different compositions across three layers. These layers typically function as a hydrophilic membrane, although there is some hydrophobic material as well. Generally, this means a solution with a similar ratio of hydrophilic to hydrophobic material to the nail will penetrate well. This concept and other characteristics of the nail surface and solution indicate how well a product will penetrate. Marlinz Pharma has utilized innovative analysis to determine how a given product interacts with and penetrates the nail plate by understanding surface tension, wettability, polar/dispersive forces ratio, homogeneity, and molecular weight. The table below illustrates how Tolcyclen compares to other antifungal products.

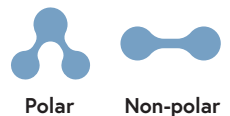

Independent Lab - Surface Tension and Contact Angle Report

	Contact Angle (θ)	Surface Tension (γ _L)	Percent Polar	Percent Dispersive
Tolcyclen	25.14	27.47	1.73	98.27
Competitor	48.37	32.27	23.18	76.82

Lower numbers mean better penetration and results Polar should be low and dispersive high to match the surface of a nail

Contact angle measurement for Tolcyclen

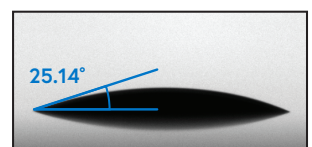

Contact angle measurement for a competitor

